

A 夾持氣孔 Clamping Port B 放鬆氣孔 Unclamping Port

外形尺寸表 Dimension table

注：上圖為轉角90°鬆開狀態 UNIT:mm

ITEM	MODEL	HASC-FA32 HASC-TB32	HASC-FA40 HASC-TB40	HASC-FA50 HASC-TB50	HASC-FA63
ST:Swing/Clamping		26; 11/15	26; 11/15	30; 13/17	30; 13/17
A1		108	108	124	124
A2		(128)	(128)	(150.4)	(150.4)
A3		127	127	146.2	146.2
B		78	78	90	90
C1		22	22	25	25
C2		12	12	15	-
D1		□19	□19	□25	□25
D2		□19	□19	□22	□22
E1		M8 x 1.25	M8 x 1.25	M10 x 1.5	M10 x 1.5
E2		Φ8	Φ8	Φ8	Φ8
F		8	8	10	10
G1		50	55	60	70
G2		140	140	160	160
H		9	9	10	10
ΦI1		Φ46	Φ55	Φ65	Φ78
ΦI2		M50 x 1.5	M55 x 1.5	M65 x 1.5	-
J		50	60	70	83
K		40	48	57	67
L		Φ5.6-Φ9 x 5.5D.	Φ6.8-Φ10.5 x 6.5D.	Φ6.8-Φ10.5 x 6.5D.	Φ9-Φ14 x 9D.
M		PT1/8	PT1/8	PT1/8	PT1/8
N		32	40	50	63
T1 x 2PCS		11	11	12	-
T2		Φ70	Φ75	Φ85	-

型號表示

重載型 HP2 B 20 10 R F A73
標準型 H P A 20 10 R F A73



安裝形式

配管	安裝形式	適合缸徑
B	螺孔及螺絲 (螺孔及螺絲規格)	Φ12, Φ16
A	筒徑螺孔	Φ20-Φ63
B	通孔	
G	螺絲規格型號	

*螺絲(以圖型的主體可選擇必須是 "F")
*重載型僅有(通孔), G.

缸徑	
12	Φ12mm
16	Φ16mm
20	Φ20mm
25	Φ25mm
32	Φ32mm
40	Φ40mm
50	Φ50mm
63	Φ63mm

*重載型沒有Φ12, Φ16

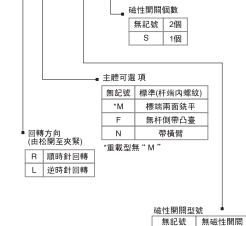

夾緊行程

配管	夾緊行程	適合缸徑
10	10mm	Φ12-Φ40
20	20mm	Φ12-Φ63
50	50mm	Φ50, Φ63

標準規格

缸徑(mm)	12	16	20	25	32	40	50	63
使用液體	空氣							
動作方式	雙作用							
最高使用壓力	1MPa							
最低使用壓力	0.1MPa							
環境和液體溫度	帶磁性開關: -10°~+60°C 無磁性開關: -10°~+70°C							
活塞速度	50~200 mm/s							
緩沖	橡膠緩沖							
行程公差 mm	±0.8 ±0.4							
*給油	不需要							
回轉角度	90° ±10°							
回轉方向	左右							
回轉行程(mm)	7.5		9.5		15		19	
夾緊行程(mm)	10, 20							
允許彎矩(N.m)	1	3.8	7	13	27	47	107	182
**夾緊力(N)	40	75	100	165	300	525	825	1400
活塞杆不回程精度	±1.4							
接管口徑	M5x0.8				Rc1/8		Rc1/4	

*加給油，請用標準1號油ISOVG32
**在0.5MPa壓力情況下

外形尺寸圖

通孔(基本型)/HPB(Φ12, Φ16, Φ20, Φ25)

Φ12

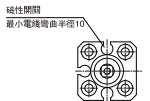

Φ16

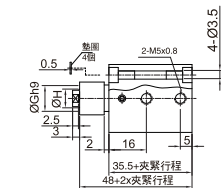
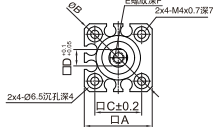

基本型

型號	A	B	C	D	E	F	Gh9	H
HPB12	25	32	15.5	5	M3X0.5	5.5	11	6
HPB16	29	38	20	7	M5X0.8	6.5	14	8

帶橫臂

型號	M	N	O	P	Q	R	S
HPB12-□□N	18.5	8	29	20	4	M3X0.5	8
HPB16-□□N	21.5	11	36	25	5	M4X0.7	11

帶橫臂/HP□16¹²-□□N

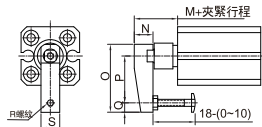

Φ20, Φ25

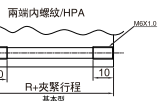
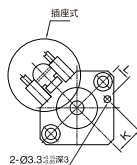
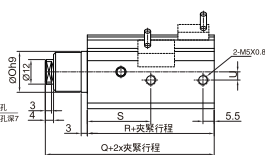
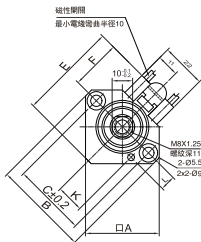

型號	A	B	C	E	F	K	L	Oh9	Q	R	S	U
HPB20	36	46.8	36	48	24.5	13.5 ^{h11}	7.5 ^{h11}	20 ^{h9}	72.5	62	31	4
HPB25	40	52	40	53.8	27.5	16 ^{h9}	8 ^{h9}	23 ^{h9}	73.5	63	32	5

注) 當活桿是完全伸出, 要把夾緊行程及回轉行程加在適當尺寸上

外形尺寸圖

通孔(基本型)/HPB(Φ32, Φ40, Φ50, Φ63)

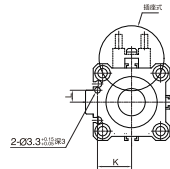
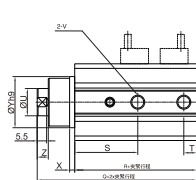
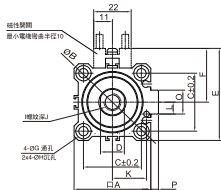

兩端內螺紋/HPA

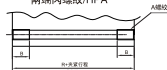

型號	A	B
HPA20	M6x1.0	10
HPA50	M8x1.25	14
HPA63	M10x1.05	18

型號	A	B	C	D	E	F	G	H	I	J	K	L	O	P	Q	R	S	T	U	V	X	Yh9	Z		
HPB32	45	60	34	14	54	31	5.5	9深7	M10x1.5	12	20 ^{h15}	7 ^{h15}	14	4	5	93	57	15	37	7	3	30	...	6.5	
HPB40	52	69	40	14	61	35	5.5	9深7	M10x1.5	12	24 ^{h15}	7 ^{h15}	14	5	94	65	29	5	8	16	Rc $\frac{1}{8}$	3	30	...	6.5
HPB50	64	86	50	17	73	41	6.6	11深8	M12x1.75	15	30 ^{h15}	8 ^{h15}	19	7	112	76	34	10	5	20	Rc $\frac{1}{8}$	3.5	37	...	7.5
HPB63	77	103	60	17	86	47.5	9	14深10.5	M12x1.75	15	35 ^{h15}	9 ^{h15}	19	7	115	80	35	10	5	20	Rc $\frac{1}{8}$	3.5	48	...	7.5

缸蓋法蘭

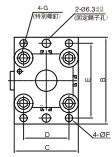
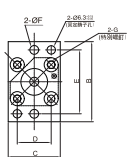
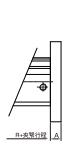

型號	適合缸徑	A	B	C	D	E	F	G	
HP-F020	20	8	60	39	25	5	48	6	M6x1.0
HP-F025	25	8	64	42	28	5.2	52	6	M6x1.0
HP-F032	32	8	65	48	34	5.6	55	5	M6x1.0
HP-F040	40	8	72	54	40	6.2	62	5	M6x1.0
HP-F050	50	9	89	67	50	7.6	68	6	M8x1.25
HP-F063	63	9	108	80	62	9	92	9	M10x1.25

桿兩面銼平 (HP□□□□)

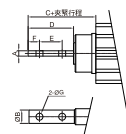

無桿缸蓋安裝型

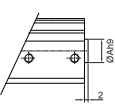

帶橫臂 (HP□□□□N)

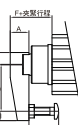
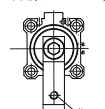

型號	Ah9	型號	A	B	C	D	F	G	H	I	型號	A	B	C	D	E	F	G
HP□20-□□F	13	HP□20-□□N	14	51	16	35	22	22	M6x1.0	7	HP□20-□□□	4	10	42.5	34	17	8.5	5.2
HP□25-□□F	15	HP□25-□□□	14	51	16	35	22	22	M6x1.0	7	HP□25-□□□	4	10	42.5	34	17	8.5	5.2
HP□32-□□F	21	HP□32-□□□	18	67	20	45	35	25	M8x1.25	10	HP□32-□□□	6	14	53.5	36	18	9	6.2
HP□40-□□F	28	HP□40-□□□	18	67	20	45	43	25	M8x1.25	10	HP□40-□□□	6	14	61	36	18	9	6.2
HP□50-□□F	35	HP□50-□□□	22	88	22	65	53	40	M10x1.5	10	HP□50-□□□	8	18	77	43	23	11	8.2
HP□63-□□F	35	HP□63-□□□	22	88	22	65	52	40	M10x1.5	10	HP□63-□□□	8	18	76.5	46	23	11	8.2